

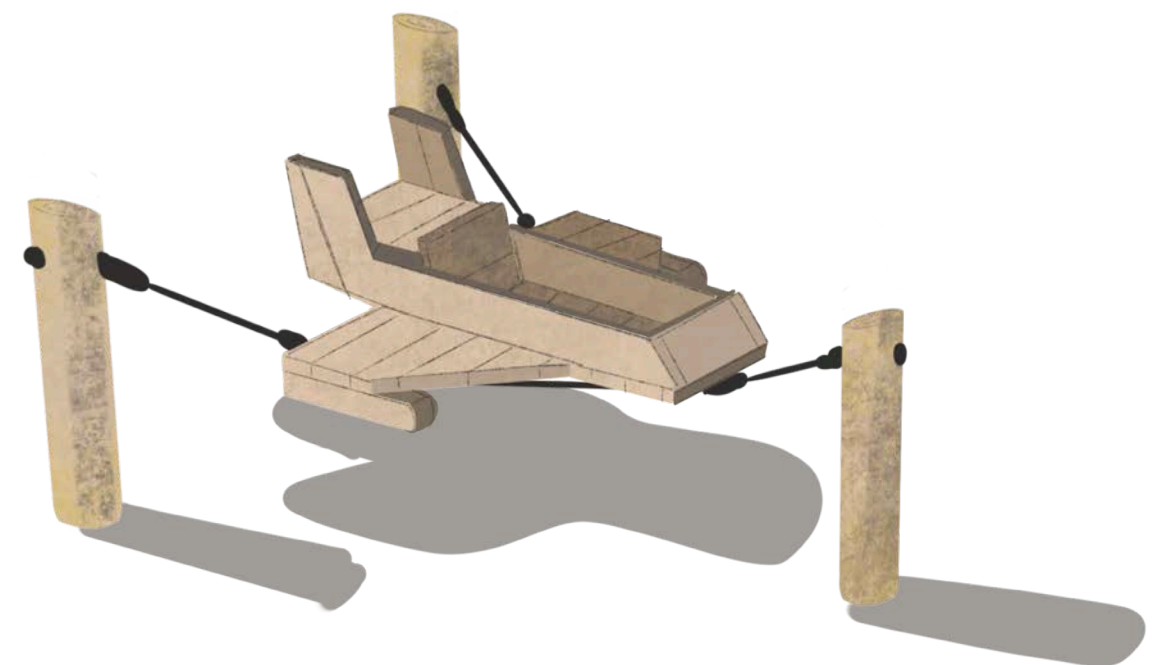

timberplay



# Timberplay Alconbury Weald Garland Park Play Proposals Consultation



Timberplay Ltd. is part of

**Create  
Partnerships**

Exclusive UK distributors of:



Richter Spielgeräte GmbH





# We Need You To Have Your Say

## Resident Consultation Outline

As the final phase of Garland Park nears, we want to get your feedback on the play options available to ensure we deliver a result you are happy with. We have been hard at work designing play experiences which are sensitive to the context, and considerate of neighbouring properties.

As a linear park the adjacency to neighbouring properties is a prime consideration, with further attention paid to sight lines and potential for noise disturbances.

We have considered the existing play equipment in Garland Park and have selected a variety of accessible and multisensory pieces accordingly, to ensure there are play opportunities for visitors of all ages and abilities, with particular focus on younger years play.

Where there is a choice to be made and your input is requested, this will be appropriately highlighted.







timberplay

# Proposed Play Equipment: Summary

Below is a summary of the proposed equipment at each station, including choice options for certain stations. Each station is broken down in further detail overleaf.

- 1 - Bespoke Pairs Game 9.15200 OR Tic Tac Toe 9.15300
- 2 - 'Runway' Wheelchair Seesaw 6.75010
- 3 - 'Hangar' Seating & Little Flyer 4.23530
- 4 - Little Speedster 4.23100 OR 2x Mini Motorbike 4.23500
- 5 - Toddlers Table & Stools 4.35050 (with Storytelling Seat)
- 6 - Small Triple Swing 6.14820 AND Step Bench 11.01300
- 7 - Triple Jumping Discs 6.06000 OR Seesaw 6.11000
- 8 - Rope Nest 4.19000 OR Climbing Pyramid 4.21100 OR Climbing Stack 4.21000

9 - Small Wheelchair Carousel 6.32500 AND Jet Plane 6.03400

10 - Rocker 6.04000 AND Platform House 2.13516

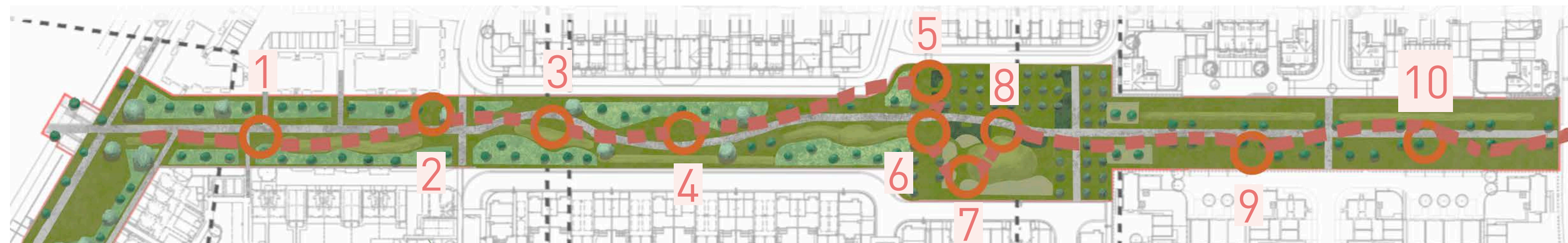
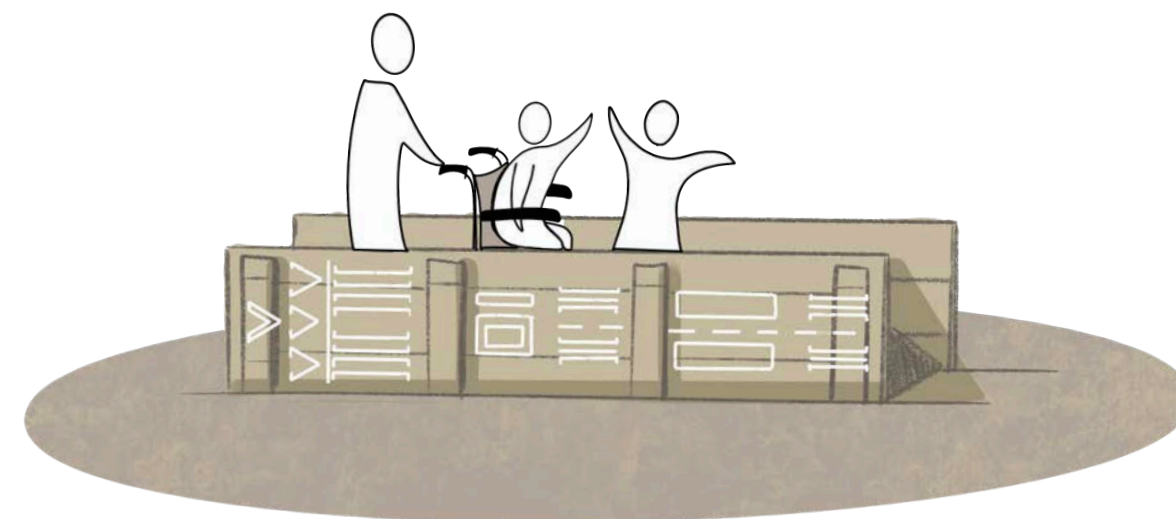





timberplay

# Proposed Play Equipment: Station 1 - OPTIONAL CHOICE

## What is it?

1 - Pairs Game 9.15200 OR  
Tic Tac Toe 9.15300

## What does it do?

Pairs Game is a fun symbol-matching game which encourages cognitive stimulation and contributes to healthy brain development. The game is suitable for ages 2+ and can be equipped with bespoke tiles to reference the RAF history local to Alconbury Weald.

Tic Tac Toe is a game of strategy for two players to enjoy.



Pairs Game 9.15200 (Accessible)



OR



Tic Tac Toe 9.15300 (Accessible)





timberplay

# Proposed Play Equipment: Station 2

What is it?

2 - Wheelchair Seesaw  
6.75010

What does it do?

Appearing as the 'Runway' in the RAF-themed play sequence, the Wheelchair Seesaw is an accessible seesaw platform which rocks up and down much like a traditional seesaw, except you can also jump on it!

This well-loved bit of kit is a great way to offer an exciting and inclusive play experience which is open to a range of ages and abilities.

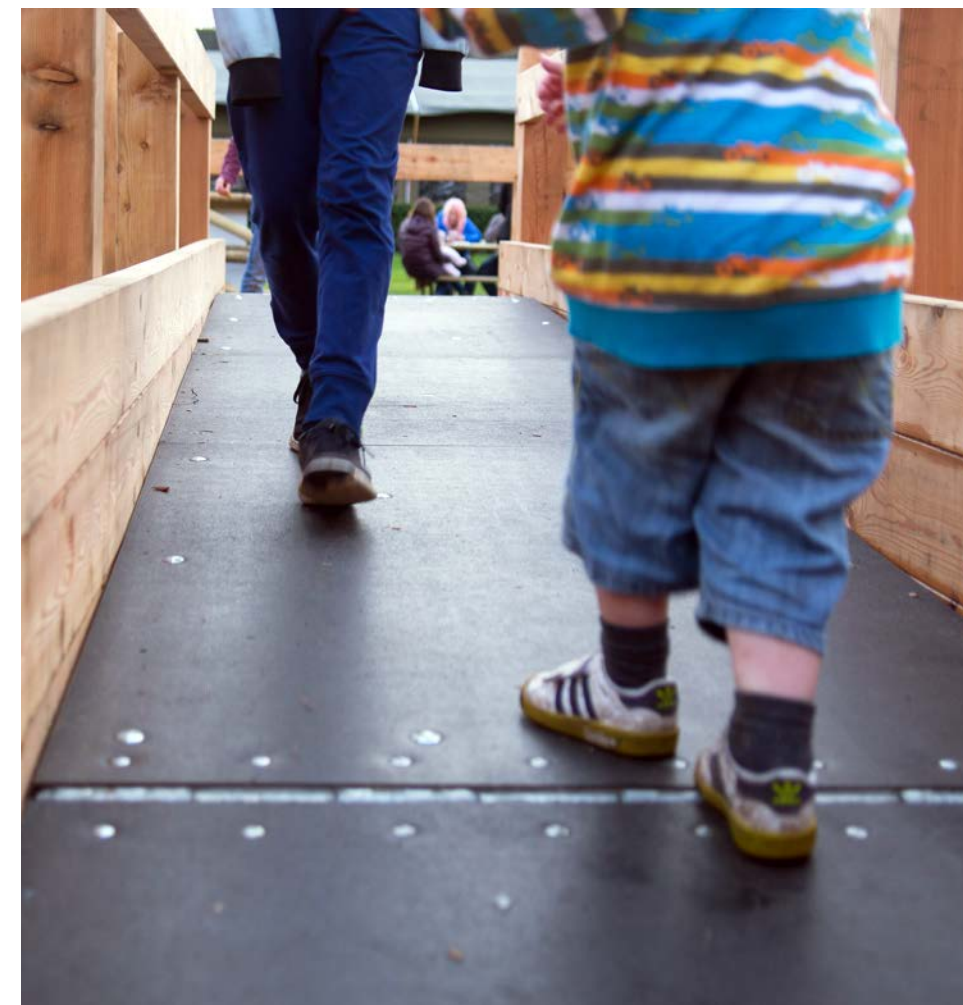
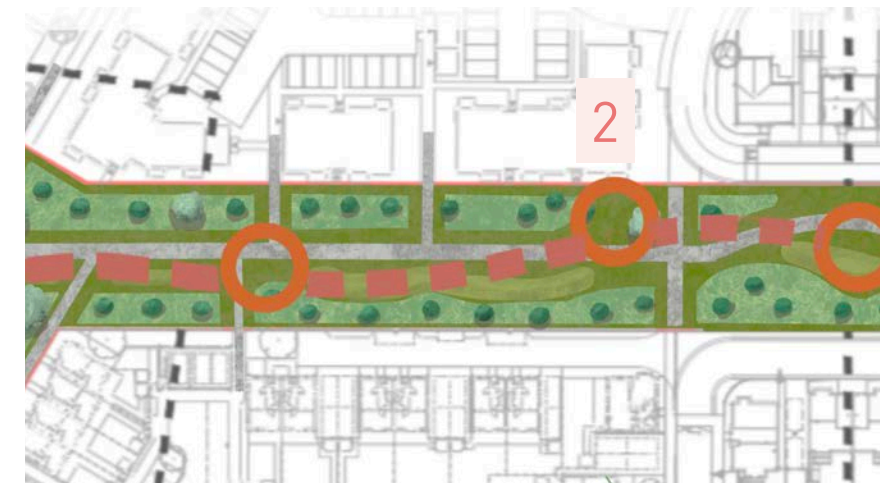

Wheelchair Seesaw 6.75010 (Accessible)





# Proposed Play: Station 3

What is it?

3 - 'Hangar' Seating & Little Flyer 4.23530

What does it do?

The 'Hangar' seating provides informal play for younger visitors who may wish to climb the steps and roll down the hill. In line with the objectives of the Make Space For Girls initiative, we wanted to ensure there was a tucked-away space to sit and relax.

Parked in the Hangar is the Little Flyer, in celebration of local RAF history.

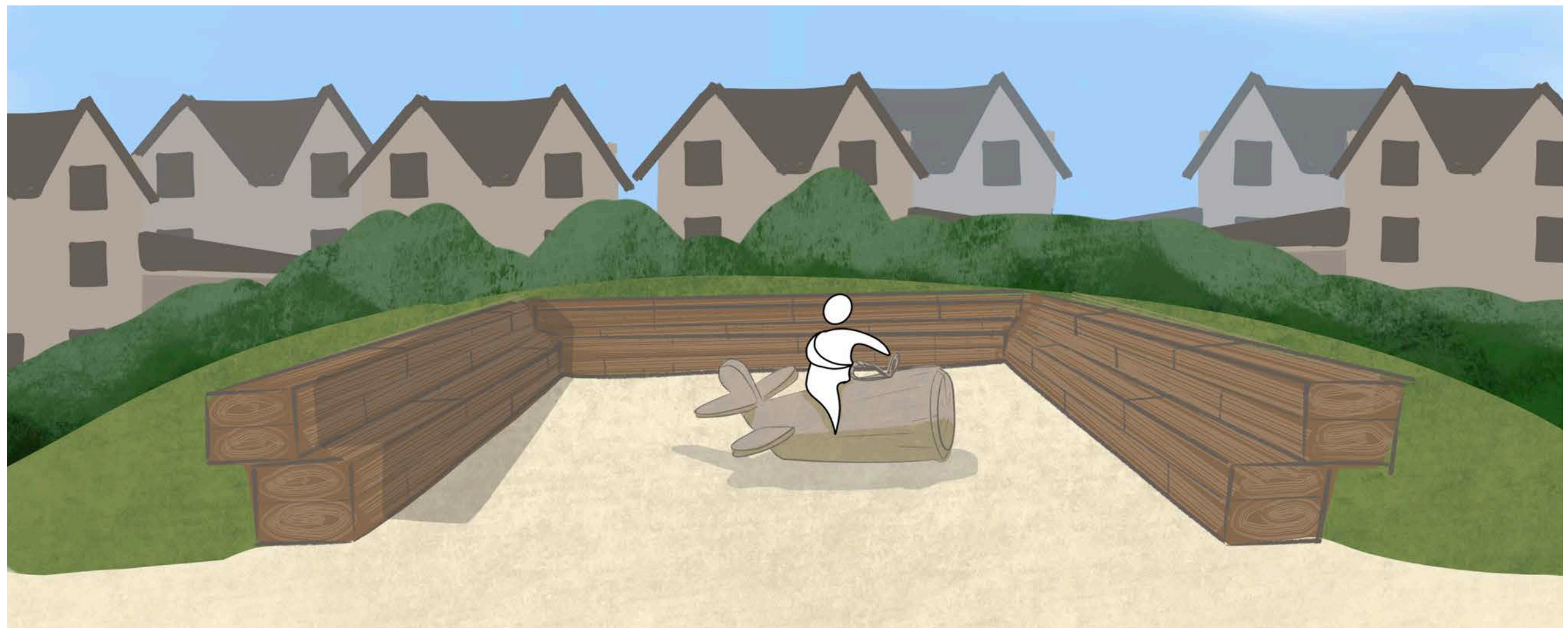

Little Flyer 4.23530

The Amphitheatre would be constructed from timber sleepers, with the ground surfacing TBD.





timberplay

# Proposed Play Equipment: Station 4 - OPTIONAL

What is it?

4 - Little Speedster 4.23100  
OR 2x Mini Motorbike 4.23500

What does it do?

The Little Speedster brings imagination / role-play value allowing users to picture themselves driving like the grown-ups do, whilst the spring-supported frame adds a fun bouncy/rocking motion to the ride. Mini Motorbikes offer similar play value, so the decision here is largely a matter of aesthetic preferences.

These pieces are located beside a proposed picnic bench, giving parents/ carers a well-deserved sit down whilst the kids enjoy themselves.



Little Speedster 4.23100

OR



2x Mini Motorbike 4.23500





timberplay

# Proposed Play Equipment: Station 5

What is it?

5 - Toddlers Table & Stools  
4.3550

What does it do?

The Toddlers Table & Stools is nestled into the proposed planting, providing space for more peaceful and contemplative play alone, or stimulating engagement in small groups.

This can be equipped with a Stool With Back 4.40050 to create a Storytelling Seat



Toddlers Table & Stools 4.3550 (Inclusive: Quiet Spaces)





timberplay

# Proposed Play Equipment: Station 6

What is it?

6 - Small Triple Swing  
6.14820 AND Step Bench  
11.01300

What does it do?

Sat opposite the Small Triple Swing, the Step Bench has seats of various heights with handles to provide a comfortable seat for users with a wide range of physical ability.

Older carers might like to improve their strength, reducing frailty and encouraging longevity, whilst they watch the swing play across from them.

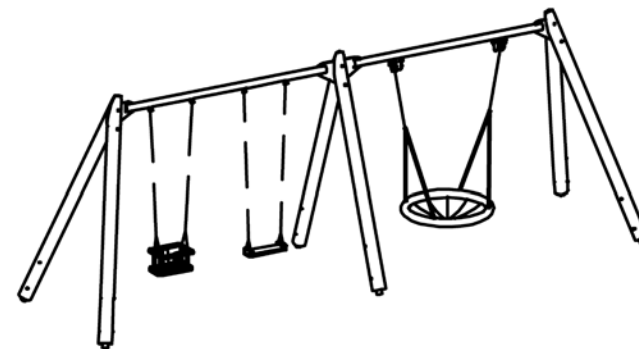
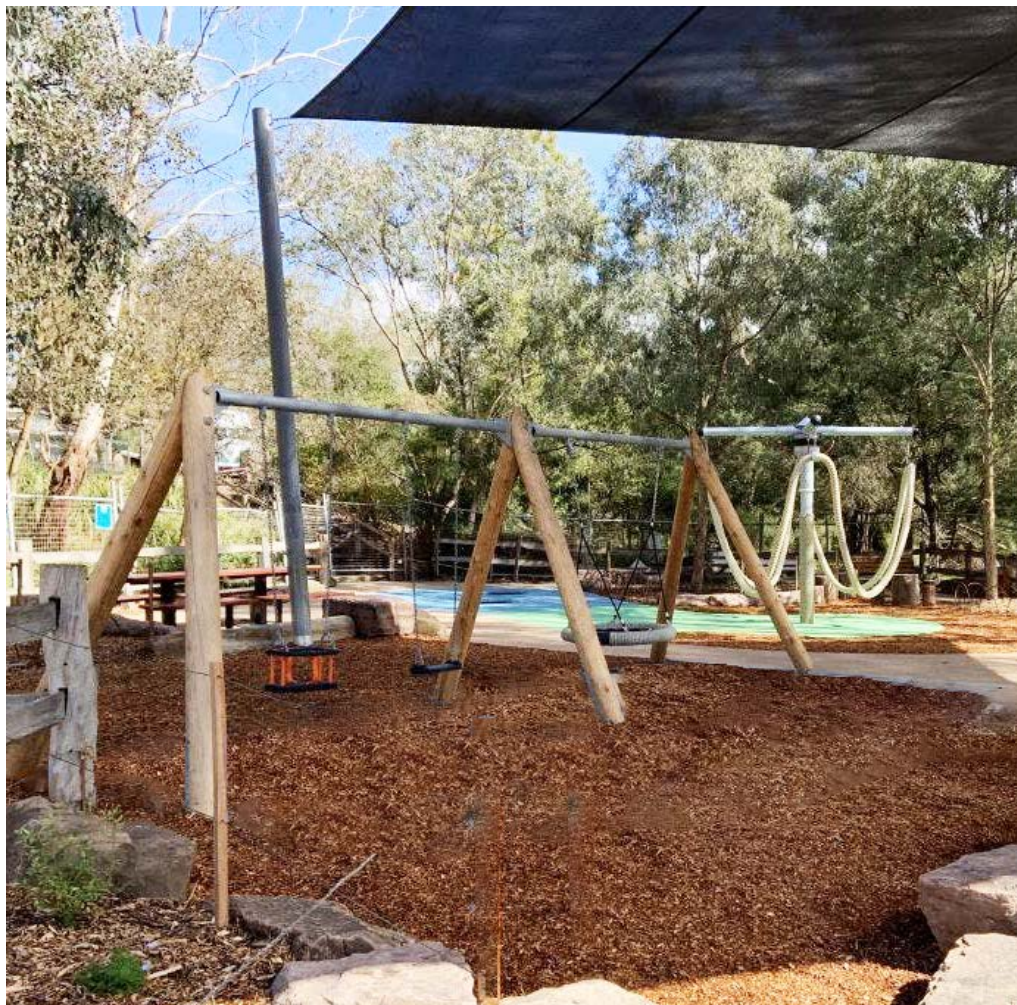

Small Triple Swing is Equipped with a toddler seat, a swing seat, and a nest swing allowing youngsters of various ability to enjoy the fun.



Small Triple Swing 6.14820 (Accessible)

**AND**

Step Bench 11.01300 (Inclusive: Multi-Generational)





timberplay

# Proposed Play Equipment: Station 7 - OPTIONAL

## What is it?

7 - Triple Jumping Discs  
6.06000 OR Seesaw  
6.11000

## What does it do?

Jumping Discs are a robust alternative to outdoor trampolines, which can easily become damaged and begin to look unsightly - When grouped in a trio like here, they allow visitors to hop along the trail.

The Seesaw is a classic piece of playground kit enjoyed for generations, and could be an alternative to the bouncing discs in this station.



Jumping Discs 6.06000

OR



Seesaw 6.11000







timberplay

# Proposed Play Equipment: Station 8 - OPTIONAL

What is it?

8 - Rope Nest 4.19000 OR  
Climbing Pyramid 4.21100  
OR Climbing Stack 4.21000

What does it do?

The options for station 8 each offer some degree of climbing and room to hang out with friends, with Rope Nest leaning more towards the latter and Climbing Stack the former, with the Climbing Pyramids climbing rungs and a net sitting somewhere between the two.



Rope Nest 4.19000

**OR**



Climbing Pyramid 4.21100

**OR**



Climbing Stack 4.21000





timberplay

# Proposed Play Equipment: Station 9

## What is it?

- 9 - Small Wheelchair Carousel 6.32500 AND Little Flyer 4.23530 OR Jet Plane 6.03400

## What does it do?

Celebrating the RAF history of the site, the Wheelchair Carousel is an accessible piece for spinning around, which can be used by both wheelchair users and non-wheelchair users. This acts as the 'target' for the Larch Jet Plane.

These fun imagination-play pieces not only inspire the next generation of pilots, but provide a recognisable wayfinding marker for visitors.

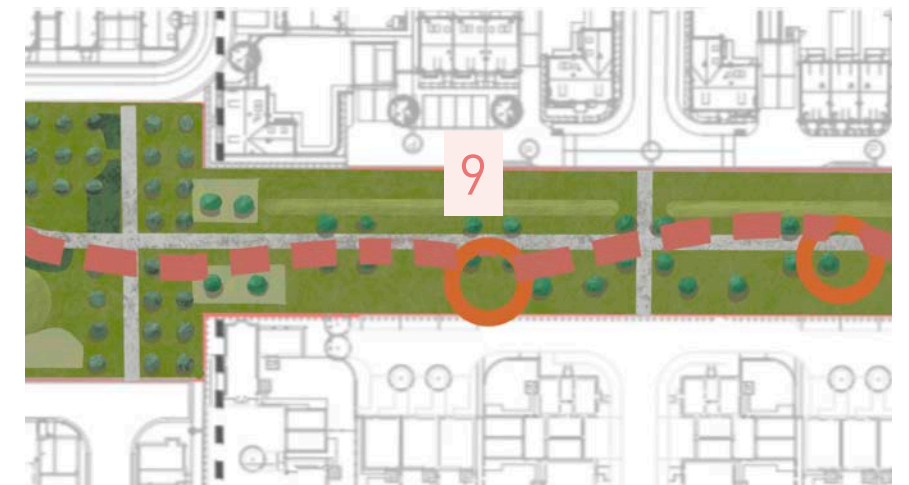

Small Wheelchair Carousel 6.32500 (Accesible)



**AND**

Jet Plane 6.03400





timberplay

# Proposed Play Equipment: Station 10

What is it?

10 - Rocker 6.04000 AND Hut Combination 351 2.13516

What does it do?

Station 10 concludes the RAF theme with the Rocker 'radio antenna' for the 'Control tower Hut Combination, complete with ramp, platform and slide.

The Rocker allows for wobbling and can be enjoyed by youngsters who are yet to take on the free-standing nature of the Jumping Discs. '

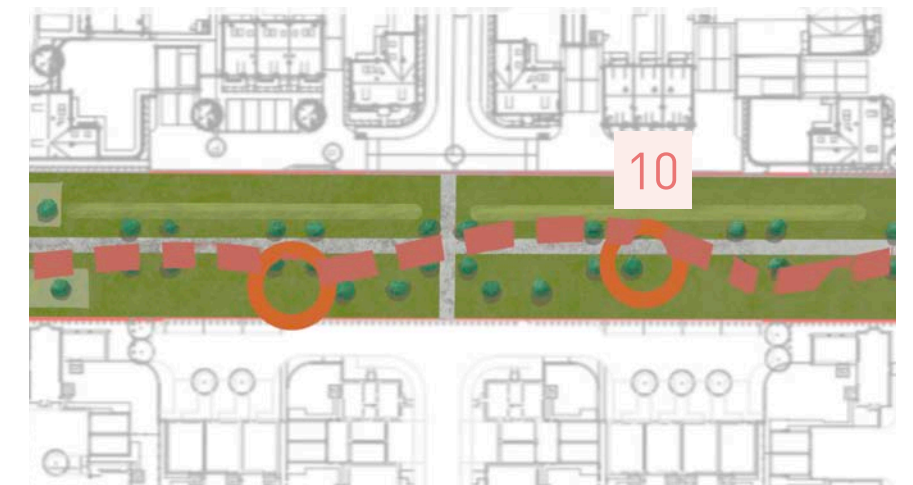

Rocker 6.04000

AND



Hut Combination 351 2.13516





timberplay



# Thank You

For taking the time to consider our proposals.





Princess Diana Memorial Playground · Mall Of Arabia · Queen Elizabeth Olympic  
Marina Promenade · Dumfries House · Chester Zoo · Darling Quarter · The Gath  
· Gorky Park, Garage Museum of Contemporary Art · Princess Diana Memorial Play  
Mall Of Arabia · Queen Elizabeth Olympic Park · Lusail Marina Promenade · Dum  
Chester Zoo · Darling Quarter · The Gathering Place · Gorky Park, Garage Muse  
Contemporary Art · Princess Diana Memorial Playground · Mall Of Arabia · Quee  
Olympic Park · Lusail Marina Promenade · Dumfries House · Chester Zoo · Darlin  
· The Gathering Place · Gorky Park, Garage Museum of Contemporary Art · Prince  
Memorial Playground · Mall Of Arabia · Queen Elizabeth Olympic Park · Lusail M  
Promenade · Dumfries House · Chester Zoo · Darling Quarter · The Gathering Pl  
Park, Garage Museum of Contemporary Art · Princess Diana Memorial Playground  
Arabia · Queen Elizabeth Olympic Park · Lusail Marina Promenade · Dumfries Ho  
Zoo · Darling Quarter · The Gathering Place · Gorky Park, Garage Museum of Cor  
· Princess Diana Memorial Playground · Mall Of Arabia · Queen Elizabeth Olympic

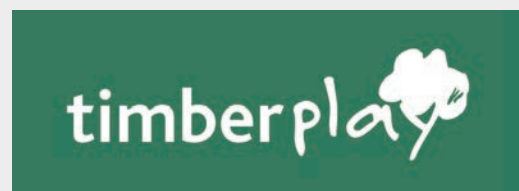

Timberplay Ltd (UK)  
Aizlewood's Mill,  
Sheffield,  
S3 8GG

t: +44 1142823474  
e: [info@timberplay.com](mailto:info@timberplay.com)  
w: [www.timberplay.com](http://www.timberplay.com)